

# Ikegami

Medical Grade Digital Video Recorder  
**MDR-600HD**

◆ High Quality - Full HD

◆ User Friendly - Simple Operation

◆ Standalone + Dual Recording

◆ Network Transfer\*



\* This may be an option in some regions.

# Ikegami's medical grade digital video recorder MDR-600HD brings high quality and convenience.

High Definition Medical Image & Video Recorder. Various types of video signals (SD & HD) can be recorded by simple operation. Reliable simultaneous recording and playback feature on Internal HDD or External USB-device are also available.



## System Configuration (example)

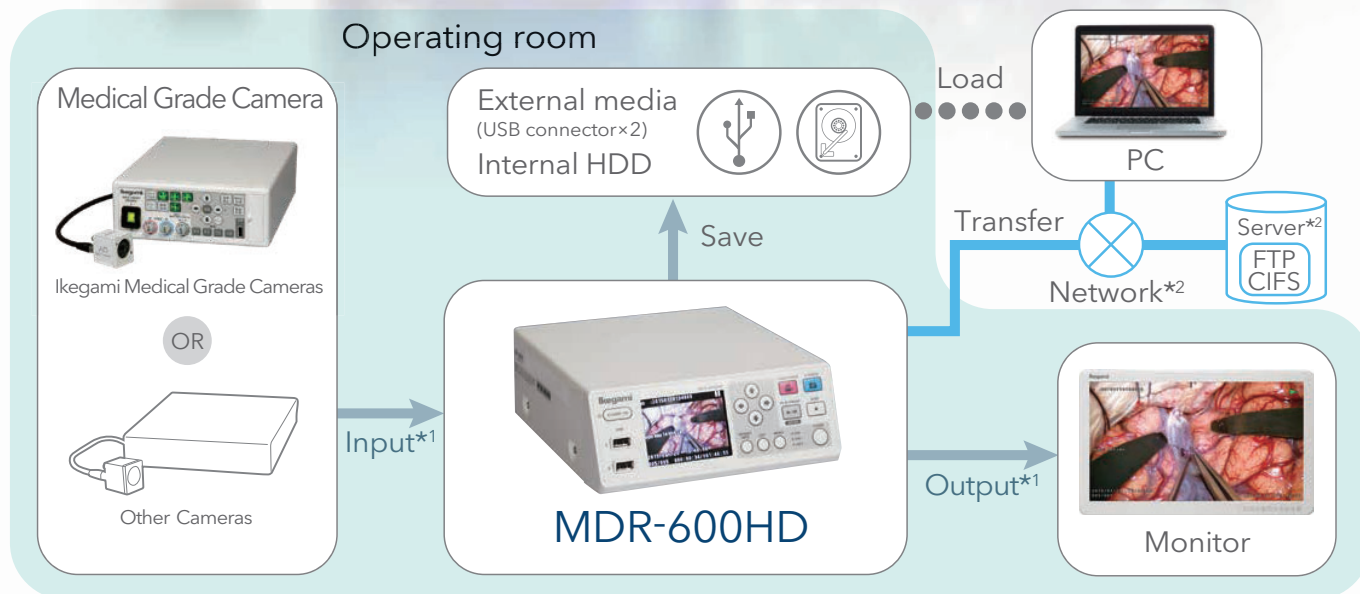

\*1 Digital:SD-SDI/HD-HDI/DVI-D Analog:COMPOSITE/S-VIDEO.Input signal and output signal must be same.  
 \*2 This may be an option in some regions.

High Quality  
Full HD

User Friendly  
Simple Operation

Standalone +  
Dual Recording

Network Transfer  
(This may be an option in some regions.)

## Key Features

### High Quality Video and Still Image

High quality SD/HD video and still image (640x480 to 1920x1080) can be recorded and played back simultaneously.

### Dual Recording Feature

Simultaneous recording feature on Internal HDD\*1 and External USB device secure data reliability. Maximum 3-way recording (Internal HDD and 2x USB devices) is available.

\*1 Internal HDD can be used to back up data.

### Auto-Signal Detection & Auto-Resolution Following

Simply connect with video input device, it enables the auto-signal detection, the auto-resolution following feature and quick-start.

### Image-Data Transfer Feature

Transferring data using LAN\*2, retrieving data from internal HDD or mass storage device using USB cable, and auto forwarding to FTP/CIFS server\*2 are available.

\*2 These functions may be options in some regions.

### Various Search Feature

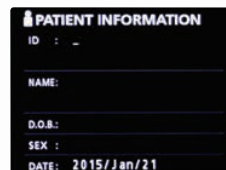

Patient data (Date, ID, Name, DOB, Sex) can be searched and reproduced quickly.



### Simultaneous Recording and Playback Feature

Still image can be saved during video recording, also video or still image can be played back during video recording period.

### Simple Operation

Just one button  can start recording video, also just  button can start recording still image.

### Built-in LCD Monitor

Recording or Playback video can be checked on a LCD monitor. Also unit status and remaining data space can be displayed.



### External Contact Switch

External contact (foot) switch can control recording start, stop and hold.

### Compact Design

Achieved high-performance and compact body.

## Recording Time

\*3,\*4

### HD (1920x1080)

Media	LQ (12 Mbps)·no audio signal	EQ (12 Mbps)	SQ (18 Mbps)	HQ (24 Mbps)
HDD (500GB)*5	100 hours	90 hours	60 hours	45 hours
External Media (1TB)	200 hours	180 hours	120 hours	90 hours

### SD (640x480)

Media	LQ (2 Mbps)·no audio signal	EQ (5 Mbps)	SQ (8 Mbps)	HQ (10 Mbps)
HDD (500GB)*5	550 hours	180 hours	135 hours	100 hours
External Media (1TB)	1100 hours	360 hours	270 hours	200 hours

\*3 Recording time in EQ, SQ, HQ mode is the time for simultaneous recording of video and audio.

\*4 Recording time in LQ mode is the time for video recording only.

\*5 If free space is less than 100GB, data will be deleted from old ones.

## Rating • Performance

Recording Media			
Internal	2.5-inch HDD (Data capacity 500GByte)		
External	USB drive (Flash Memory or HDD)*1 *1 USB memory has no warranty.		
Display	3.5-inch, Full Color LCD		
Input Signal			
Video	Digital (High Resolution Video)		
	HD-SDI	1080p, 1080i, 720p, 480i, 576i	
	DVI-D	640 x 480 - 1920 x 1200 (1920 x 1200 will be reduced to 1728 x 1080)	
	Analog (NTSC/PAL)		
	COMPOSITE	1.0 Vp-p 75Ω	
	S-VIDEO	1.0 Vp-p 75Ω luminance signal NTSC 0.286 Vp-p 75Ω chrominance signal PAL 0.3 Vp-p 75Ω chrominance signal	
Audio*2	Digital	Embedded (SDI input)	
	Analog	Audio	-9.4dBv 10kΩ or more, unbalance φ3.5 stereo mini-jack
		MIC	φ3.5 monaural mini-jack (Plug-in Power)
Output Signal			
Video	Digital (High Resolution Video)		
	HD-SDI	1080p, 1080i, 720p, 480i, 576i	
	DVI-D	640 x 480 - 1920 x 1200	
	Analog (NTSC/PAL)		
	COMPOSITE	1.0 Vp-p 75Ω	
	S-VIDEO	1.0 Vp-p 75Ω luminance signal NTSC 0.286 Vp-p 75Ω chrominance signal PAL 0.3 Vp-p 75Ω chrominance signal	
Audio*2	Digital	Embedded (SDI input)	
	Analog	Audio	-6dBv 1kΩ unbalance φ3.5 stereo mini-jack

\*2 Input/output of analog audio is not available when audio is embedded in the SDI signal.

Interface	
LAN	RJ45 (100Base-TX/1000Base-T)*3 (This function may be an option in some regions.)
USB-A	Recording x 2 (Front USB2.0)
USB-B	For PC connection x 1 (Rear USB2.0)
REMOTE	2.5-inch mini-jack
Contact Switch	3.5-inch mini-jack, Video x 1, Photo x 1
External Recording Media	
USB Drive	Flash Memory or HDD
Format	FAT32
Video Data Process	
Still Image	JPEG
Video Compression	H.264
File Format	mov
Recording Time	90 hours. (Internal HDD 500GB, EQ: Economy Quality)
Audio Data Process	
Compression	LPCM
Sampling Freq	48KHz
Quantifying Bit Number	16bit

## Safety Regulation/EMC

Safety Regulation	CB (IEC60601-1), CE (EN60601-1), NRTL/C (UL/CSA60601-1)
EMC	IEC60601-1-2, CSA60601-1-2, EN60601-1-2, FCC class B
Certified	FDA/Medical Class1

## General

Power	AC 100V - 240V ±10% 50/60 Hz 0.62A - 0.35A	
Operating Environment	Temperature	5 - 40°C
	Humidity	5 - 80% RH (non-condensing)
Dimension	W210.5 x H88.5 x D235mm (incl.rubber foot)	
Weight	Approx. 2.6kg	
Standard Accessory	Power cord x 1, Instruction Manual x 1	

\*3 Data transfer rate is limited to 100\_Mpbs to ensure the stability of recording.

## Rear Panel



## Optional Unit



## Dimensions (Unit:mm)

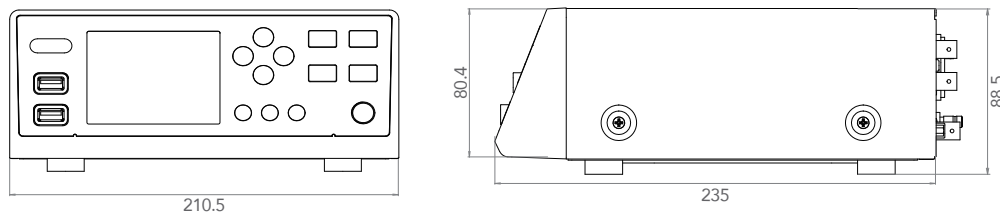

Design and specifications are subject to change without notice.

# INSPIRE MEDITECH PRIVATE LIMITED

407 Red Rose Building 49-50, Nehru Place New Delhi-110019

Office +91 11 26284578, 79, 80

H/P+919811078156, 919313899647, 919717480657

sales@inspiremeditech.com | www.inspiremeditech.com

